

NOTE: Drawings show ovens equipped with casters. .

**PS540-1
TOP VIEW**

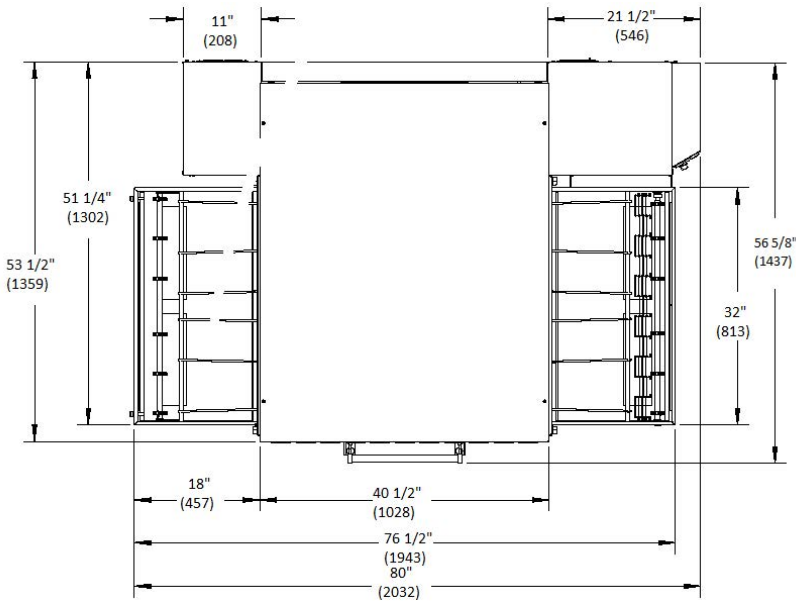

NOTE: All drawings show ovens equipped with casters. Adjustable feet that replace the casters are available as an option.

① Electrical Junction Box

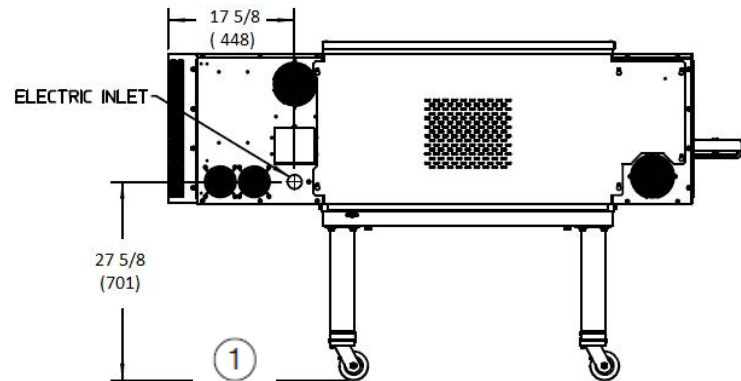
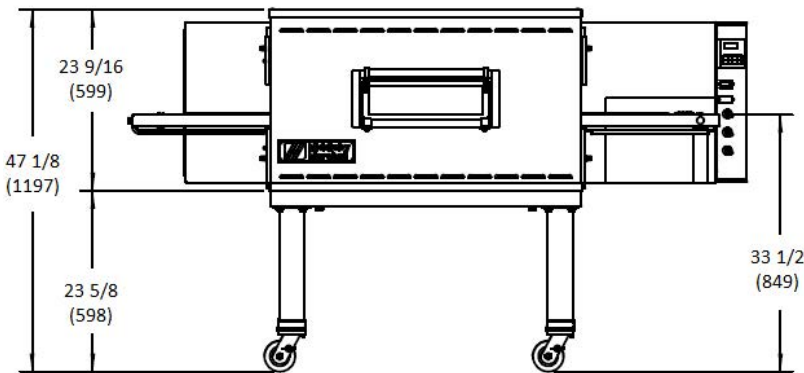

FRONT VIEW

BACK VIEW

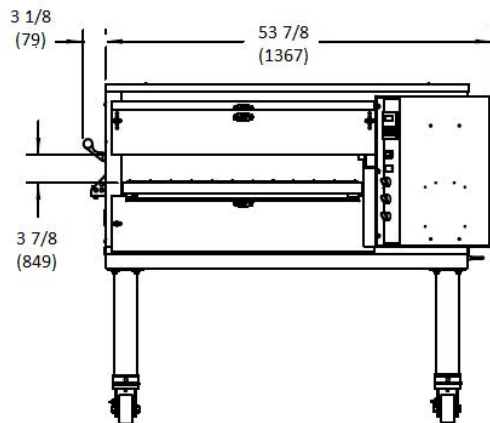

SIDE VIEW

**PS540 Series
Electrically Heated Conveyor Oven**

NOTE: Drawings show ovens equipped with casters.

PS540-2

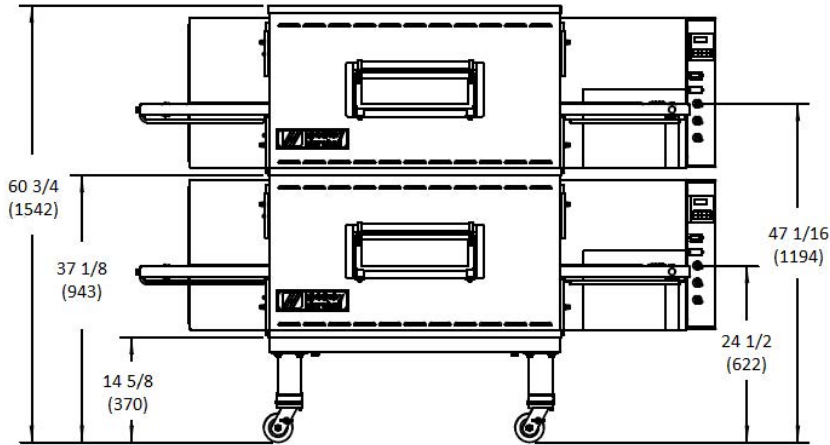

FRONT VIEW

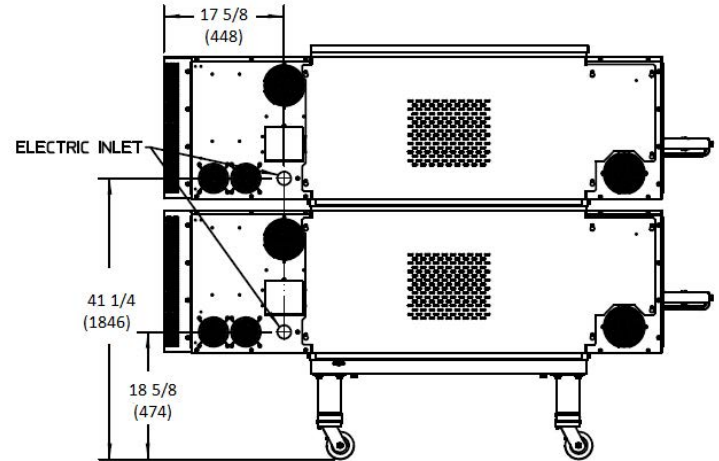

BACK VIEW

PS540-3

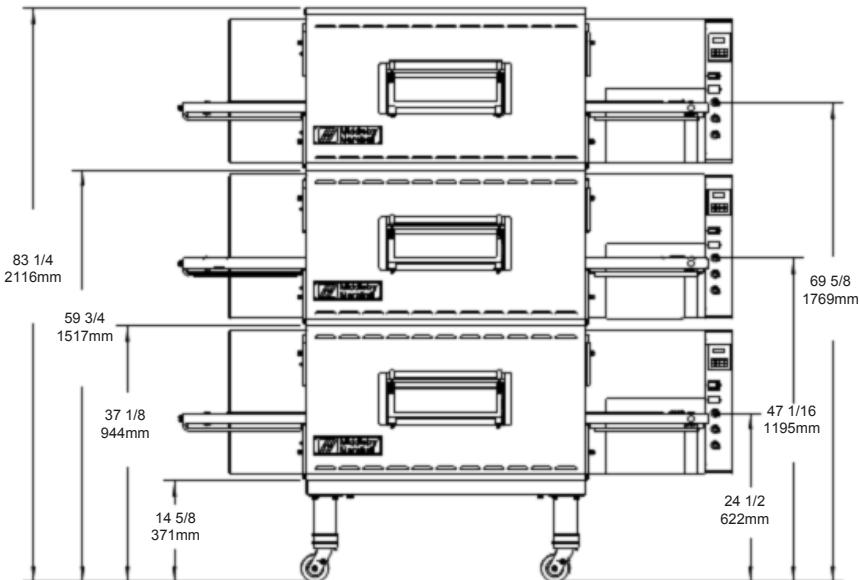

FRONT VIEW

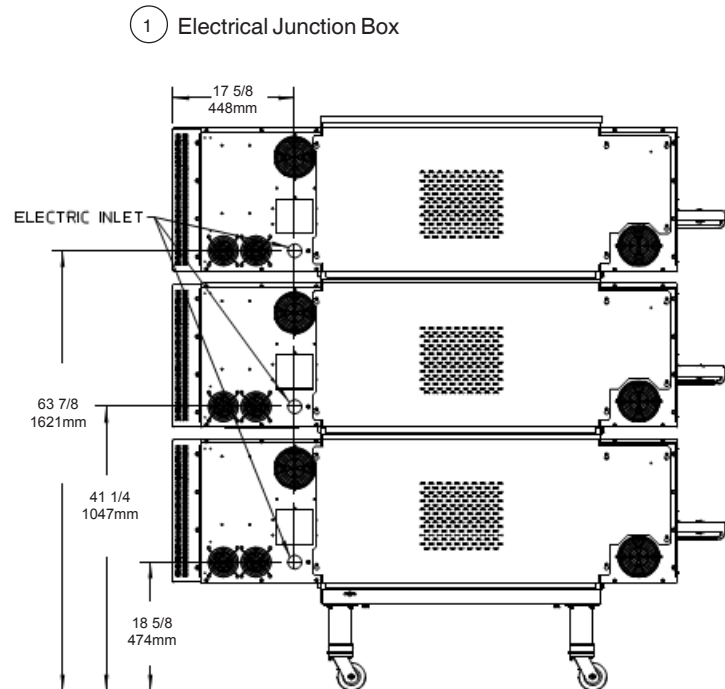

BACK VIEW

RECOMMENDED MINIMUM CLEARANCES

Rear of Oven to Wall	Control end of conveyor to wall	Non-control end of conveyor to wall
0"	0"	0"

GENERAL SPECIFICATIONS

	Heating Zone	Baking Area	Belt Length	Belt Width	Length	Height	Depth	Maximum Operating Temp	Bake Time Range	Ship Wt	Ship Cube
PS540-1	40-1/2" 1028mm	9sq.ft. 0.837m ²	76-1/2" 1943mm	1x32" (813mm) or 2x15"(381mm)	80" 2032mm	47-1/8" 1197mm	56-5/8" 1437mm	550°F 288°C	1:00-30:00	1100lbs. 499kg	132ft ³ 3.70m ³
PS540-2	81" 2056mm	18sq.ft. 1.674m ²	76-1/2" 1943mm	1x32" (813mm) or 2x15"(381mm)	80" 2032mm	60-3/4" 1542mm	56-5/8" 1437mm	550°F 288°C	1:00-30:00	2200lbs. 999kg	264ft ³ 7.39m ³
PS540-3	121-1/2" 3084mm	27sq.ft. 2.511m ²	76-1/2" 1943mm	1x32" (813mm) or 2x15"(381mm)	80" 2032mm	76" 1930mm	56-5/8" 1437mm	550°F 288°C	1:00-30:00	3300lbs. 1498kg	396ft ³ 11.09m ³

ELECTRICAL SPECIFICATIONS

Voltage	Phase	Freq	Rated Heat Input	Amperage*				Max Amperage*	Supply	Breakers
				L1	L2	L3	N			
208v	3	50/60 Hz	27.0 kW					79Amp	3 pole, 4 wire (3 hot, 1 ground)	As per local codes
240v	3	50/60 Hz	27.0 kW					69Amp	3 pole, 4 wire (3 hot, 1 ground)	As per local codes
380v	3	50/60 Hz	27.0 kW					45Amp	4 pole, 5 wire (3 hot, 1 neut, 1 grnd)	As per local codes
480v	3	50/60 Hz	27.0 kW					36Amp		
380VCE	3	50/60 Hz	27.0 kW					45Amp	4 pole, 5 wire (3 hot, 1 neut, 1 grnd)	As per local codes

* The current draw rating shown above are maximum values for normal operation, amperage draw will be less than the listed value.

ALL SPECIFICATIONS SUBJECT TO CHANGE WITHOUT NOTICE.